



INDEX





**Multiblindo**  **Motion**  
Electromechanical  
automatic lock



## Multiblindo eMotion

Perfect combination of comfort and security in any situation.

The new electromechanical automatic lock represents the electronic evolution of Multiblindo Easy.

From the outside it operates by key or the most advanced electronic access control systems: fingerscan, keyboard, transponder, PIN-code. From the inside it operates electronically in a simple and fast way through a normal keyboard, allowing the end user to set three different locking functions: Total, Light, Free.



### It is certified

according to EN14846:08 and prEN15685:09 European standards.

Multiblindo eMotion ensures top-level intrusion protection; it doesn't lose the settings in case of a blackout and, if necessary, it always assures the mechanical key or handle action.

Example of certification: EN14846:2008



### With sound feedback

A special system monitors the door status and sends opening and closing sound signals, which can be set or completely excluded by the end user.

### Set your time

The user can set the time span between the opening pulse and the automatic relocking of the door.



Multiblindo eMotion has three options allowing an instant opening as well as to choose the automatic relocking mode according to the user's security requirements. It is operated through an electronic control for all the settings.

**Total.** When pressing the pushbutton the door opens and a sound signal is produced. When it closes, Multiblindo eMotion will automatically trigger the latchbolt and deadbolts: the sound feedback will indicate the total locking. Total security: this setting ensures your door the highest security.

**Light.** When pressing the pushbutton the door opens and a sound signal is produced. When it closes, Multiblindo eMotion will automatically trigger the latchbolt only: a different and more flexible security level for a partial and fast locking.

**Free.** With this setting, Multiblindo eMotion keeps the latchbolt and deadbolts completely unlocked: the door will stay in a free-opening status, in the classic hold-open situation. Total freedom ensuring a free access both from inside and outside until a new setting is given.

### Doors opening direction.

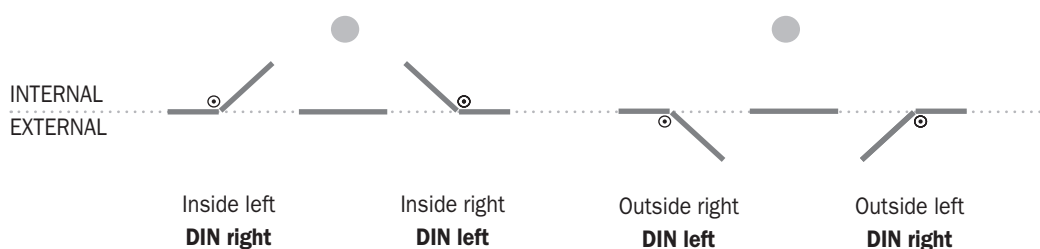

**Multiblando**  **Motion**

**CLASS  
C**

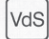

# Zertifikat

über die  
**Anerkennung**  
von  
Bauteilen und Systemen

---

Inhaber der Anerkennung:  
**Iseo Serrature s.p.a.**  
Via S. Girolamo 13  
IT-25055 Pisogne (BS)

Anerkennung Nr.	Anzahl der Seiten	Gültig vom	Gültig bis
M 110357	4	08.12.2009	08.12.2010

Gegenstand der Anerkennung:  
**Zylinderschloss - Klasse C  
Baureihe Multiblando**

Verwendung:  
**als mechanische Sicherungseinrichtung**

Anerkennungsgrundlagen:  
**VdS 2344 : 2005-12, Verfahren für die Prüfung, Anerkennung und Konformitätsbewertung von Geräten, Bauteilen und Systemen der Brandschutz- und Sicherungstechnik**  
**VdS 2841 : 2005-12, Durchführung von Produktüberwachungen**  
**VdS 2201 : 2004-02, Richtlinien für mechanische Sicherungseinrichtungen, Zylinderschlösser, Anforderungen und Prüfmethoden**  
**DIN 18 251-3 : 2002-11, Schlösser, Einsteckschlösser als Mehrfachverriegelung**

Köln, den 10. Dezember 2010



Schlingel  
Geschäftsführer

**VdS Schadenverhütung GmbH**  
Zertifizierungsstelle  
Anwaltsstraße 114  
D-50735 Köln

Ein Unternehmen des Gesamtverbandes der Deutschen Versicherungsgesellschaft e.V. (GDV) an der Spitze der Zertifizierungsstelle für die Bereiche Brandschutz- und Sicherungstechnik von der Deutschen Akkreditierungsstelle Technisch (DATechn)

**VDS** is an independent German institute. A VDS certification helps end users to distinguish high quality from mediocre products and services. ISEO Serrature has obtained the highest security certification for Multiblando product range, **CLASS C**.



**Multiblindo Motion 92 mm centre distance**

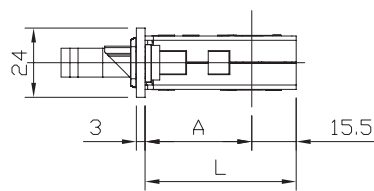
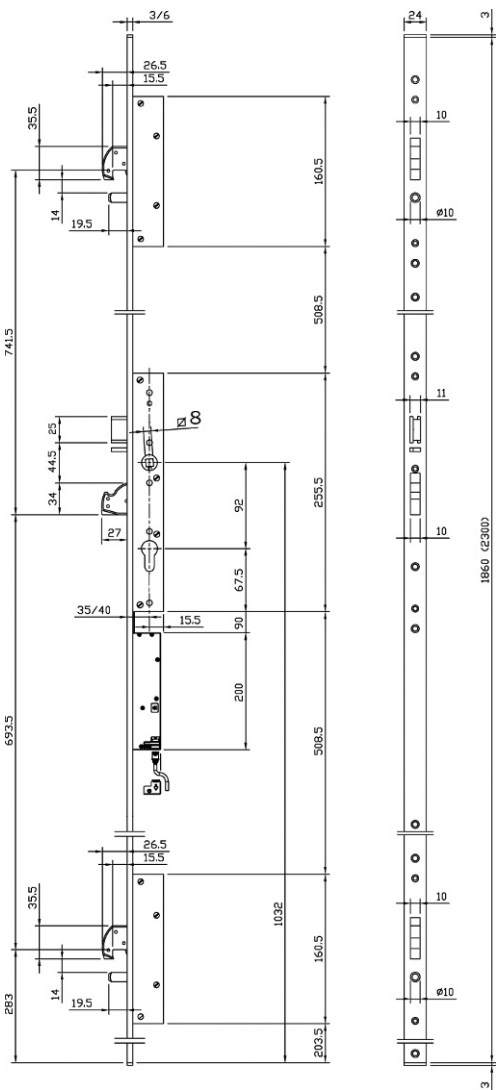
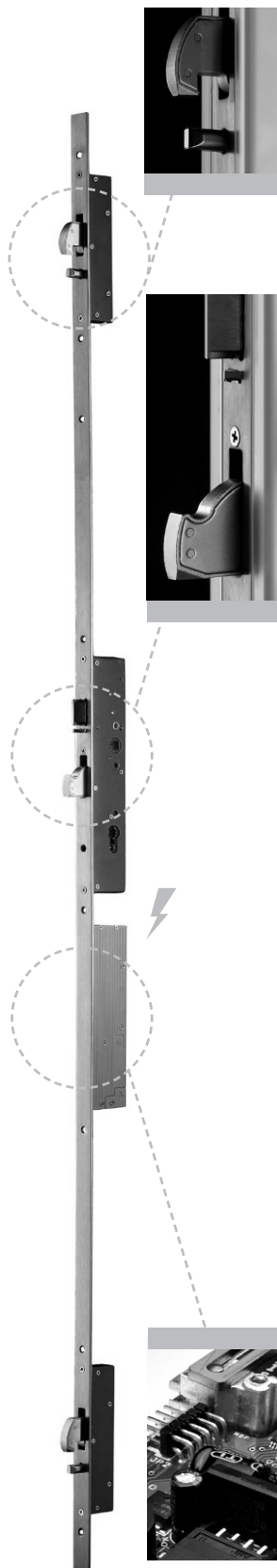

ENTRATA	A	L
35	32	47.5
40	37	52.5
45	42	57.5
50	47	62.5
55	52	67.5
60	57	72.5
65	62	77.5

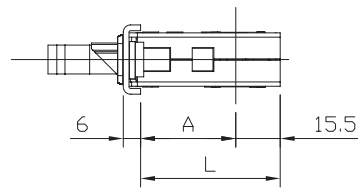

ENTRATA	A	L
35	28	43.5
40	33	48.5
45	38	53.5
50	43	58.5
55	48	63.5
60	53	68.5
65	58	73.5

**ELECTROMECHANICAL 12Vdc** MULTIPOINT mortice lock for metal frames,  
AUTOMATIC LOCKING OF THE LATCHBOLT AND 3 DEADBOLTS, **ROTATING HOOK DEVIATORS**.

Central lock, centre distance mm 92, operating with European profile cylinder.

Right or left latchbolt, **non reversible**.

Deadbolts and latchbolt operated by key, handle or motor.

Lock and deviators deadbolts mm 27 throw, with anti-drill and anti-cut cover plates in carbonitrided steel.

6 mt connection cable, 2 nylon end blocks for U-version. Fixing screws. Instruction sheet.

**Accessories to be ordered separately:**

Striking plates **U-front plate**

mechanical strikers 033232 - 033233

strikers for deviators 033167 - 033171

**Flat front plate**

mechanical striker 033230 - 033231

strikers for deviators 033165 - 033169



Code

Single  
package

Multiple  
package

Min. ord.

## Multiblindo Motion 92 mm centre distance

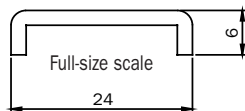

U-front plate mm <b>2300x24x6</b> in stainless steel. Backset mm 35 <b>DIN RIGHT</b>	<b>7A3600352.D</b>	1	-	1
U-front plate mm <b>2300x24x6</b> in stainless steel. Backset mm 40 <b>DIN RIGHT</b>	<b>7A3600402.D</b>	1	-	1
U-front plate mm <b>2300x24x6</b> in stainless steel. Backset mm 45 <b>DIN RIGHT</b>	<b>7A3600452.D</b>	1	-	1
U-front plate mm <b>2300x24x6</b> in stainless steel. Backset mm 50 <b>DIN RIGHT</b>	<b>7A3600502.D</b>	1	-	1
U-front plate mm <b>2300x24x6</b> in stainless steel. Backset mm 55 <b>DIN RIGHT</b>	<b>7A3600552.D</b>	1	-	1
U-front plate mm <b>2300x24x6</b> in stainless steel. Backset mm 60 <b>DIN RIGHT</b>	<b>7A3600602.D</b>	1	-	1
U-front plate mm <b>2300x24x6</b> in stainless steel. Backset mm 65 <b>DIN RIGHT</b>	<b>7A3600652.D</b>	1	-	1
U-front plate mm <b>2300x24x6</b> in stainless steel. Backset mm 35 <b>DIN LEFT</b>	<b>7A3600352.S</b>	1	-	1
U-front plate mm <b>2300x24x6</b> in stainless steel. Backset mm 40 <b>DIN LEFT</b>	<b>7A3600402.S</b>	1	-	1
U-front plate mm <b>2300x24x6</b> in stainless steel. Backset mm 45 <b>DIN LEFT</b>	<b>7A3600452.S</b>	1	-	1
U-front plate mm <b>2300x24x6</b> in stainless steel. Backset mm 50 <b>DIN LEFT</b>	<b>7A3600502.S</b>	1	-	1
U-front plate mm <b>2300x24x6</b> in stainless steel. Backset mm 55 <b>DIN LEFT</b>	<b>7A3600552.S</b>	1	-	1
U-front plate mm <b>2300x24x6</b> in stainless steel. Backset mm 60 <b>DIN LEFT</b>	<b>7A3600602.S</b>	1	-	1
U-front plate mm <b>2300x24x6</b> in stainless steel. Backset mm 65 <b>DIN LEFT</b>	<b>7A3600652.S</b>	1	-	1

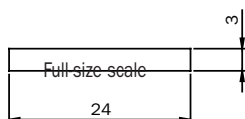

Flat front plate mm <b>2300x24x3</b> in stainless steel. Backset mm 35 <b>DIN RIGHT</b>	<b>7A3610352.D</b>	1	-	1
Flat front plate mm <b>2300x24x3</b> in stainless steel. Backset mm 40 <b>DIN RIGHT</b>	<b>7A3610402.D</b>	1	-	1
Flat front plate mm <b>2300x24x3</b> in stainless steel. Backset mm 45 <b>DIN RIGHT</b>	<b>7A3610452.D</b>	1	-	1
Flat front plate mm <b>2300x24x3</b> in stainless steel. Backset mm 50 <b>DIN RIGHT</b>	<b>7A3610502.D</b>	1	-	1
Flat front plate mm <b>2300x24x3</b> in stainless steel. Backset mm 55 <b>DIN RIGHT</b>	<b>7A3610552.D</b>	1	-	1
Flat front plate mm <b>2300x24x3</b> in stainless steel. Backset mm 60 <b>DIN RIGHT</b>	<b>7A3610602.D</b>	1	-	1
Flat front plate mm <b>2300x24x3</b> in stainless steel. Backset mm 65 <b>DIN RIGHT</b>	<b>7A3610652.D</b>	1	-	1
Flat front plate mm <b>2300x24x3</b> in stainless steel. Backset mm 35 <b>DIN LEFT</b>	<b>7A3610352.S</b>	1	-	1
Flat front plate mm <b>2300x24x3</b> in stainless steel. Backset mm 40 <b>DIN LEFT</b>	<b>7A3610402.S</b>	1	-	1
Flat front plate mm <b>2300x24x3</b> in stainless steel. Backset mm 45 <b>DIN LEFT</b>	<b>7A3610452.S</b>	1	-	1
Flat front plate mm <b>2300x24x3</b> in stainless steel. Backset mm 50 <b>DIN LEFT</b>	<b>7A3610502.S</b>	1	-	1
Flat front plate mm <b>2300x24x3</b> in stainless steel. Backset mm 55 <b>DIN LEFT</b>	<b>7A3610552.S</b>	1	-	1
Flat front plate mm <b>2300x24x3</b> in stainless steel. Backset mm 60 <b>DIN LEFT</b>	<b>7A3610602.S</b>	1	-	1
Flat front plate mm <b>2300x24x3</b> in stainless steel. Backset mm 65 <b>DIN LEFT</b>	<b>7A3610652.S</b>	1	-	1

Power supply **230Vac - 12Vdc - 3A** **94403000E** 1 - 1

External soft cable tube L=300 - opening up to 180° **94403010E** 1 - 1



Built-in soft cable tube L=260 - opening up to 90° **94403110E** 1 - 1

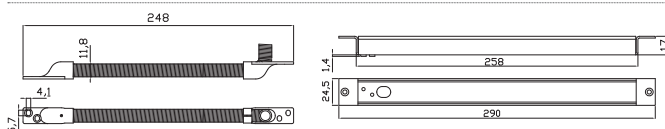





## Multiblando eMotion EXIT

The new electromechanical automatic lock Multiblando eMotion EXIT with panic function has got the same features as the lock Multiblando eMotion. The system is made up of the lock and the operating bar. A microswitch detects and signals the deadbolt status. From the outside it operates by key or the most advanced electronic access systems: fingerscan, keyboard, transponder, PIN-code.

From the inside it operates electronically in a simple and fast way through a normal keyboard. The end user can choose the locking mode according to his security requirements: Total, Light, Free. The deadbolts and latchbolt are always operated by the panic bar.



### It is certified

according to the EN 1125:08 standard in combination with its striking plates and operating bar Pro EXIT, with the following certification:



### Pro EXIT operating bar

Operating bar on which a microswitch can be applied. It detects the emergency opening. **With AntiGerm antibacterial protection.**



### Set your time

The user can set the time span between the opening pulse and the automatic relocking of the door.

Multiblando eMotion has three options allowing an instant opening as well as to choose the automatic relocking mode according to user's security requirements. It is operated through an electronic control for all the settings.

**Total.** When pressing the pushbutton the door opens and a sound signal is produced. When it closes, Multiblando eMotion will automatically trigger the latchbolt and deadbolts: the sound feedback will indicate the total locking. Total security: this setting ensures your door the highest security.

**Light.** When pressing the pushbutton the door opens and a sound signal is produced. When it closes, Multiblando eMotion will automatically trigger the latchbolt only: a different and more flexible security level for a partial and fast locking.

**Free.** With this setting, Multiblando eMotion keeps the latchbolt and deadbolts completely unlocked: the door will stay in a free-opening status, in the classic hold-open situation. Total freedom ensuring a free access both from inside and outside until a new setting is given.



**Multiblindo eMotion EXIT 92 mm centre distance**

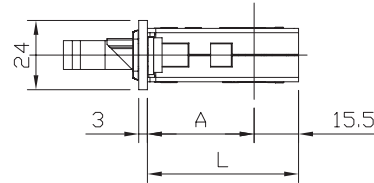
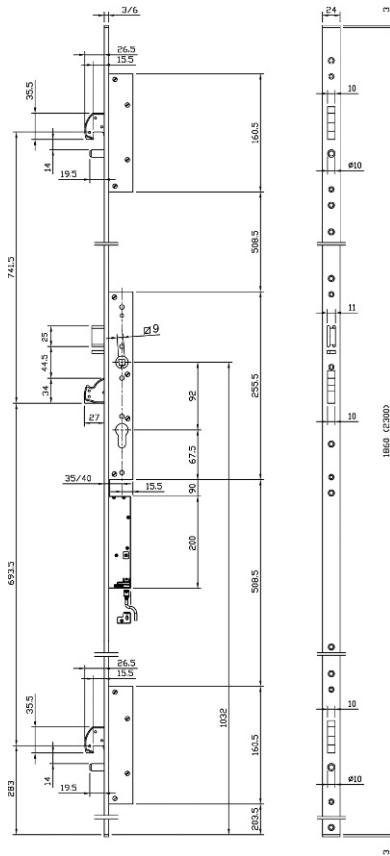
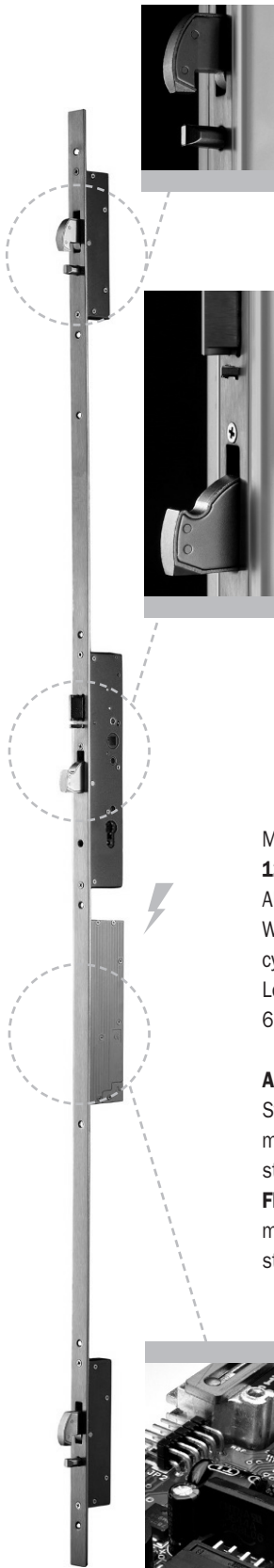

ENTRATA	A	L
35	32	47.5
40	37	52.5
45	42	57.5
50	47	62.5
55	52	67.5
60	57	72.5
65	62	77.5

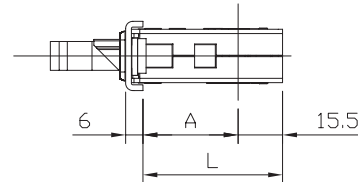

ENTRATA	A	L
35	28	43.5
40	33	48.5
45	38	53.5
50	43	58.5
55	48	63.5
60	53	68.5
65	58	73.5

Multiblindo eMotion EXIT with panic function is operated by an horizontal bar and is made up of the **ELECTROMECHANICAL 12Vdc MULTIPOINT** mortice lock for metal frames in combination with its striking plates, and operating bar Pro EXIT.

**AUTOMATIC LOCKING OF THE LATCHBOLT AND 3 DEADBOLTS, ROTATING HOOK DEVIATORS.**

With microswitch detects and signals the deadbolt status. Central lock, centre distance mm 92, operating with European profile cylinder. Right or left latchbolt, **non reversible**. Deadbolts and latchbolt operated by key, handle or motor.

Lock and deviators deadbolts mm 27 throw, with anti-drill and anti-cut cover plates in carbonitrided steel.

6 mt connection cable, 2 nylon end blocks for U-version. Fixing screws. Instruction sheet.

**Accessories to be ordered separately:**

Striking plates **U-front plate**

mechanical strikers 033232 - 033233

strikers for deviators 033167 - 033171

**Flat front plate**

mechanical striker 033230 - 033231

strikers for deviators 033165 - 033169

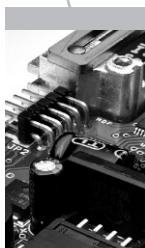





Code

Single  
package

Multiple  
package

Min. ord.

## Multiblindo Motion EXIT 92 mm centre distance

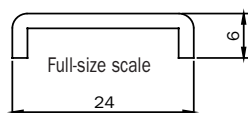

U-front plate mm <b>2300x24x6</b> in stainless steel. Backset mm 35 <b>DIN RIGHT</b>	<b>7A37003521D.A</b>	1	-	1
U-front plate mm <b>2300x24x6</b> in stainless steel. Backset mm 40 <b>DIN RIGHT</b>	<b>7A37004021D.A</b>	1	-	1
U-front plate mm <b>2300x24x6</b> in stainless steel. Backset mm 45 <b>DIN RIGHT</b>	<b>7A37004521D.A</b>	1	-	1
U-front plate mm <b>2300x24x6</b> in stainless steel. Backset mm 50 <b>DIN RIGHT</b>	<b>7A37005021D.A</b>	1	-	1
U-front plate mm <b>2300x24x6</b> in stainless steel. Backset mm 55 <b>DIN RIGHT</b>	<b>7A37005521D.A</b>	1	-	1
U-front plate mm <b>2300x24x6</b> in stainless steel. Backset mm 60 <b>DIN RIGHT</b>	<b>7A37006021D.A</b>	1	-	1
U-front plate mm <b>2300x24x6</b> in stainless steel. Backset mm 65 <b>DIN RIGHT</b>	<b>7A37006521D.A</b>	1	-	1
U-front plate mm <b>2300x24x6</b> in stainless steel. Backset mm 35 <b>DIN LEFT</b>	<b>7A37003521S.A</b>	1	-	1
U-front plate mm <b>2300x24x6</b> in stainless steel. Backset mm 40 <b>DIN LEFT</b>	<b>7A37004021S.A</b>	1	-	1
U-front plate mm <b>2300x24x6</b> in stainless steel. Backset mm 45 <b>DIN LEFT</b>	<b>7A37004521S.A</b>	1	-	1
U-front plate mm <b>2300x24x6</b> in stainless steel. Backset mm 50 <b>DIN LEFT</b>	<b>7A37005021S.A</b>	1	-	1
U-front plate mm <b>2300x24x6</b> in stainless steel. Backset mm 55 <b>DIN LEFT</b>	<b>7A37005521S.A</b>	1	-	1
U-front plate mm <b>2300x24x6</b> in stainless steel. Backset mm 60 <b>DIN LEFT</b>	<b>7A37006021S.A</b>	1	-	1
U-front plate mm <b>2300x24x6</b> in stainless steel. Backset mm 65 <b>DIN LEFT</b>	<b>7A37006521S.A</b>	1	-	1

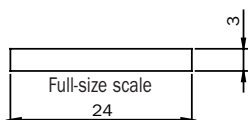

Flat front plate mm <b>2300x24x3</b> in stainless steel. Backset mm 35 <b>DIN RIGHT</b>	<b>7A37103521D.A</b>	1	-	1
Flat front plate mm <b>2300x24x3</b> in stainless steel. Backset mm 40 <b>DIN RIGHT</b>	<b>7A37104021D.A</b>	1	-	1
Flat front plate mm <b>2300x24x3</b> in stainless steel. Backset mm 45 <b>DIN RIGHT</b>	<b>7A37104521D.A</b>	1	-	1
Flat front plate mm <b>2300x24x3</b> in stainless steel. Backset mm 50 <b>DIN RIGHT</b>	<b>7A37105021D.A</b>	1	-	1
Flat front plate mm <b>2300x24x3</b> in stainless steel. Backset mm 55 <b>DIN RIGHT</b>	<b>7A37105521D.A</b>	1	-	1
Flat front plate mm <b>2300x24x3</b> in stainless steel. Backset mm 60 <b>DIN RIGHT</b>	<b>7A37106021D.A</b>	1	-	1
Flat front plate mm <b>2300x24x3</b> in stainless steel. Backset mm 65 <b>DIN RIGHT</b>	<b>7A37106521D.A</b>	1	-	1
Flat front plate mm <b>2300x24x3</b> in stainless steel. Backset mm 35 <b>DIN LEFT</b>	<b>7A37103521S.A</b>	1	-	1
Flat front plate mm <b>2300x24x3</b> in stainless steel. Backset mm 40 <b>DIN LEFT</b>	<b>7A37104021S.A</b>	1	-	1
Flat front plate mm <b>2300x24x3</b> in stainless steel. Backset mm 45 <b>DIN LEFT</b>	<b>7A37104521S.A</b>	1	-	1
Flat front plate mm <b>2300x24x3</b> in stainless steel. Backset mm 50 <b>DIN LEFT</b>	<b>7A37105021S.A</b>	1	-	1
Flat front plate mm <b>2300x24x3</b> in stainless steel. Backset mm 55 <b>DIN LEFT</b>	<b>7A37105521S.A</b>	1	-	1
Flat front plate mm <b>2300x24x3</b> in stainless steel. Backset mm 60 <b>DIN LEFT</b>	<b>7A37106021S.A</b>	1	-	1
Flat front plate mm <b>2300x24x3</b> in stainless steel. Backset mm 65 <b>DIN LEFT</b>	<b>7A37106521S.A</b>	1	-	1